

"Smell the Rubber"

Custom Chrome Series Microphone Stand with One-hand Height Adjustment and Free Gig Bag – Circular Sweep Base with '60s-style Shifter Clutch

Stunning and Sturdy

Custom Chrome Series mic stands feature a gorgeous chrome finish that look stunning under stage lights. Additionally, the chrome finish means that your Custom Chrome Series mic stand will not rust or corrode as you take it from gig to gig – even after years of use! Custom Chrome Series mic stands are as sturdy as they are stunning!

What's Your Personality?

The "Smell the Rubber" Custom Chrome mic stand is a modern symbol for a classic theme – the style and muscle of a '60s stick shift combined with the sweeping speed of laying down rubber in a back ally drag race. Strap on your seat belt and push your audience to the edge of g-force entertainment with a "Smell the Rubber" Custom Chrome mic stand today!

One-hand Height Adjustment

Ultimate Support invented the one-hand height-adjustable mic stand nearly two decades ago. Custom Chrome Series mics stands feature Ultimate Support's patented one-hand clutch mechanism housed inside fun and ergonomic designs. Simply squeeze the non-slip, die-cast ergonomic clutch to quickly raise or lower your microphone.

Free Gig Bag Included

Transport your Custom Chrome mic stand to your gigs – and store them after – with the included gig bag. Equipped with an internal pocket for the base, and plenty of room for the mic shaft (and whatever else you'd like to store there), the free gig bag will keep your stand free from blemishes and will ensure that you don't lose any pieces and parts of your mic rig ever again!

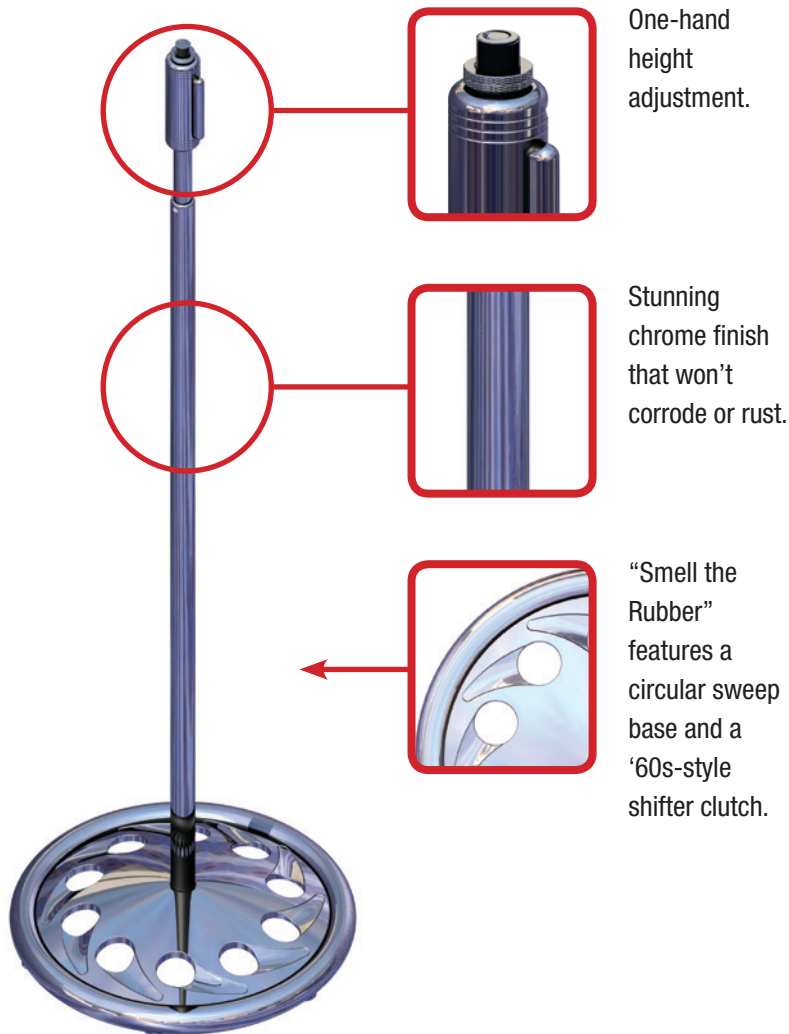

CUSTOM-6 SPECS

- Height 40" - 64" (1016 mm - 1626 mm)
- Weight approx. 8 lbs. (3.6 kg)
- Base diameter 14" (356 mm)



**Custom Tote Bag
Included for FREE!**



CUSTOM CHROME -SERIES

Are you ready to add some personality to your stage presence? The Custom Chrome Series from Ultimate Support feature a one-hand height adjustment for maximum flexibility, a super strong and reflective finish that looks stunning under stage lights, unique personality-driven designs, and ships with a gig bag that houses the base and the mic shaft (plus whatever else you want to put in it). The Custom Chrome Series are a must-have for any lead singer's arsenal and sure to become the centerpiece of any stage!



CUSTOM-1
"ARE YOU TALKIN' TO ME?"



CUSTOM-2
"DARK MAGIC"



CUSTOM-3
"BRING IT ON, SUCKA!"



CUSTOM-4
"LOVE · HATE"



CUSTOM-5
"Venom"



CUSTOM-6
"Smell the Rubber"